

Moving Resident to and from Bathing System

Warning

Before using the Secure-Glide™ Transfer System be sure:

1. Only trained and authorized personnel conduct resident transfers with this system.
2. Carrier latches securely to the tub.
3. Chair is locked to the base's primary lock.
4. Seat belts are in good condition and secured to chair.
5. All scheduled preventative maintenance has been completed.

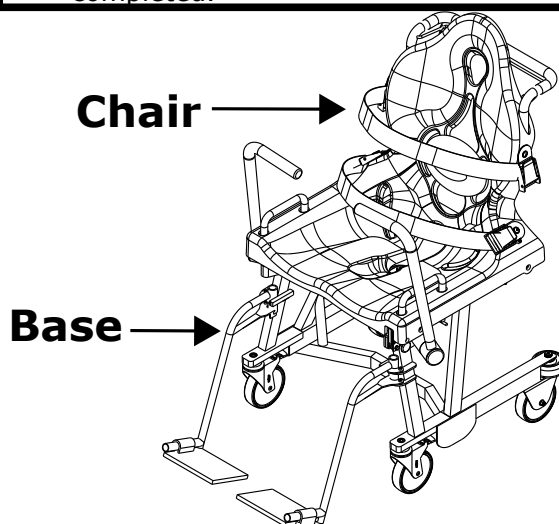

Resident Transfers in or out of Chair

- 1 Lock casters
- 2 Verify the chair is slid all the way forward and that primary lock is engaged.
 (Chair should not move relative to the base if the primary lock is engaged.)
- 3 Lower the armrests to the down position by pulling them to the outside and pushing them forward
- 4 Transfer resident in/ out of the chair.
- 5 Return armrests to the raised position.
- 6 Fasten Seatbelts

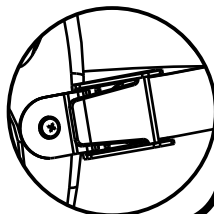
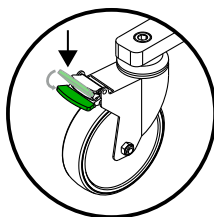

Transferring Resident into Tub

- 1 Open Door
- 2 Dock Carrier to tub and verify that it is secure by pulling it away from the tub.
 (The carrier should not release from the tub.)
- 3 Lock casters
- 4 Verify screen indicates that it's safe to transfer.
- 5 Press down on the primary lock release.
- 6 Lift secondary lock handle and glide the chair into the tub.
- 7 Unlock casters
- 8 Push the carrier release button twice to unlatch the carrier from the tub.

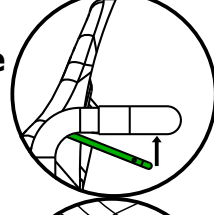
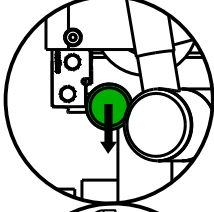
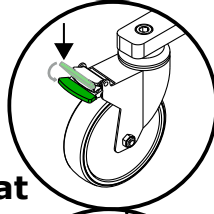
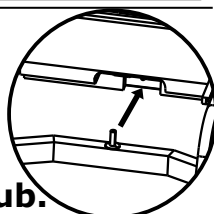

Transferring Resident out of Tub

- 1 Open Door
- 2 Dock Carrier to tub and verify that it is secure by pulling it away from the tub.
 (The carrier should not release from the tub.)
- 3 Lock casters
- 4 Verify screen indicates that it's safe to transfer.
- 5 lift secondary lock handle and glide the chair onto the base.
- 6 Verify the chair is slid all the way forward and that primary lock is engaged.
 (Chair should not move relative to the base if the primary lock is engaged.)
- 7 Unlock casters
- 8 Push the carrier release button twice to unlatch the carrier from the tub.

